

REV.	DESCRIPTION	DRW. CHK.	APP.	DATE
A	RELEASE			

**SPECIFICATIONS**

Current Rating:  
1 AC, DC  
Voltage Rating:  
50 AC, DC

Insulator resistance:  
1000 Megohms Min.  
Contact Resistance:  
20 m ohms Max.

Dielectric withstanding:  
AC 500V/minute

Operating Temperature:  
-25° ~ +85° C

Contact Material:  
Phosphor Bronze

Insulator Material:  
Nylon 6T UL94V-0

Color: Natural(White)  
Finish:  
Tin Plated

**RoHS Compliant**

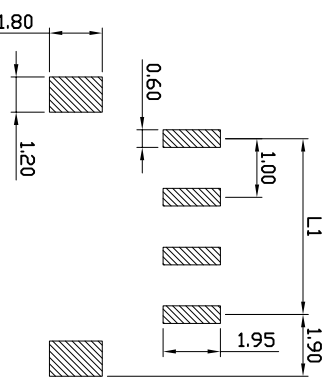

RECOMMENDED P. C. B. LAYOUT

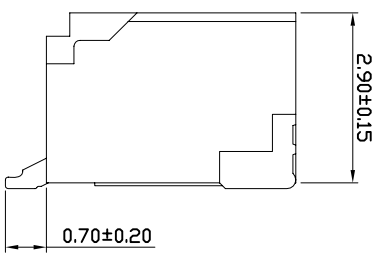
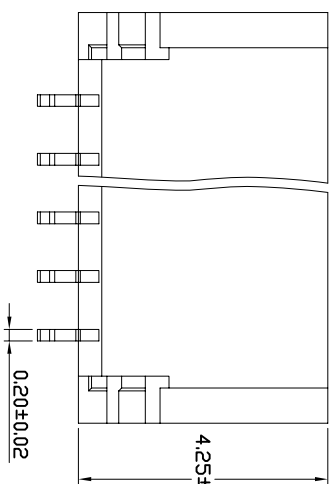
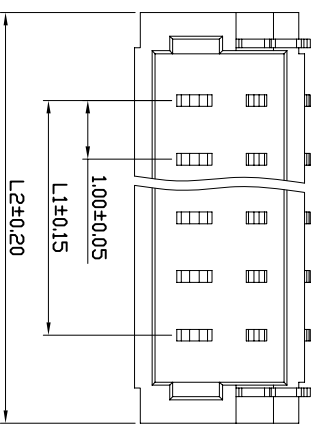

Ordering information:  
**24W1111-XXM20-01T**

Number of Contact  
02~20

M SMT

G Gold Plated  
T Tin Plated  
Contact Plating  
01 Normal

0 Color: Natural(White)

Cir-cuits	Dimension mm	
	L1	L2
2	1.00	4.00
3	2.00	5.00
4	3.00	6.00
5	4.00	7.00
6	5.00	8.00
7	6.00	9.00
8	7.00	10.00
9	8.00	11.00
10	9.00	12.00
11	10.00	13.00
12	11.00	14.00
13	12.00	15.00
14	13.00	16.00
15	14.00	17.00
16	15.00	18.00
17	16.00	19.00
18	17.00	20.00
19	18.00	21.00
20	19.00	22.00

**成品規格圖**

TITLE	1.00mm Wafer 90° SMT	APP.	
PART NO	24W1111-XXM20-01T	CHK.	
DRW NO	24W0092	DR.	Ken Wang
UNIT	mm(INCH)	PROJECT	98.03.17

ANGLES	±3°	SIZE	A4
LINEAR	0.0 ±0.50	SCALE	4:1
	0.00±0.25	SHEET	1/1

