

REV.	DESCRIPTION	DRW.	CHK.	APP.	DATE
A	RELEASE				

SPECIFICATIONS

Current Rating:

3 Amp

Insulator resistance:

5000 Megohms Min.

Contact resistance:

20 m ohms Max.

Dielectric withstanding:

AC 1000V/minute

Operating Temperature:

-40° ~ +105°C

Contact Material:

BRASS

Insulator Material:

High Temperature Thermoplastic

+Glass Fibre UL94V-0

Color: Black

Finish:

Gold, Tin or Duplex plated

Standard: Gold flash all over

Duplex plated:

Gold plated on contact area

Tin on solder area

RoHS Compliance

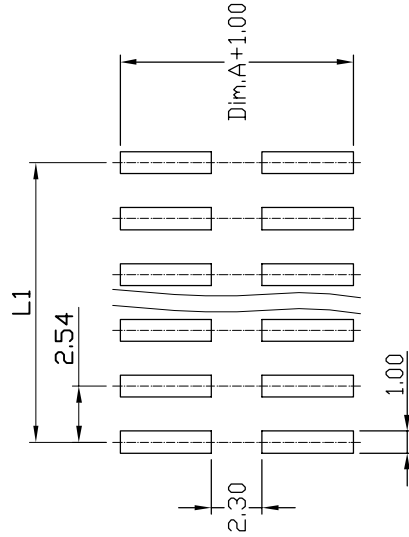

RECOMMENDED P. C. B. LAYOUT

Ordering information:

23X6960-XXMXX-XXX-A

N Nylon-6T
L LCP

Number of Contact

06, 08, 10, 12, 14,
16, 20, 24, 26, 30,
34, 40, 50, 60, 64.

Dimension

10 = 1.00mm
15 = 1.50mm
XX = X.YYmm

Dimension
Standard 9.60mm

G Gold Plated

T Tin Plated

H Duplex Plated

Contact Plating

01 Normal

10 10 μ"

: :

: :

Color

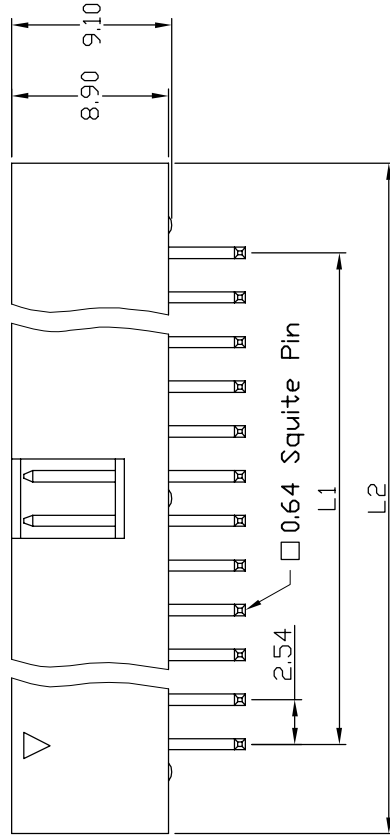
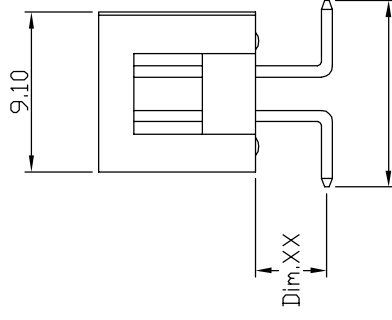
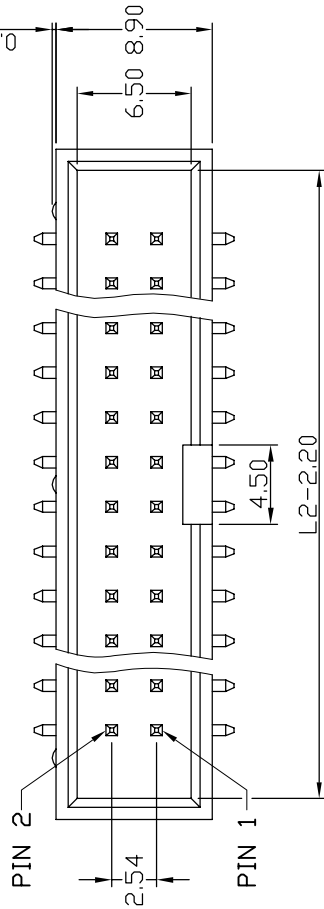

Ref.

成品規格圖

TITLE	2.54mm Box Header SMT Type
PART NO	23X6960-XXMXX-XXX-A
DRW NO	
UNIT	mm(INCH) PROJECT

APP.	
CHK.	
DR.	KEN
96.01.04	

ANGLES	±3°	SIZE	A4
LINEAR	0.0 ±0.38	SCALE	3:1
	0.00±0.25	SHEET	1/1

