

REV.	DESCRIPTION	DRW.	CHK.	APP.	DATE
A	RELEASE				

SPECIFICATIONS

Current Rating:
1 Amp
Insulator resistance:
1000 Megohms Min.
Contact resistance:
25 m ohms Max.
Dielectric withstanding:
AC 500V/minute
Operating Temperature:
-40° ~ +105°C
Contact Material:
Brass
Insulator Material:
High Temperature Thermoplastic
+Glass Fibre UL94V-0
Color: Black
Finish:
Gold, Tin or Duplex plated
Standard: Gold flash all over
Duplex plated:
Gold plated on contact area
Tin on solder area

RoHS Compliance

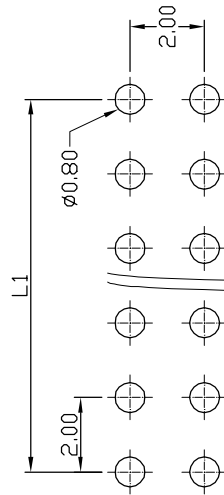

RECOMMENDED P. C. B. LAYOUT

Ordering information:

23N6850-XXS20X-XXX

N Nylon-6T
G Gold Plated
T Tin Plated
H Duplex Plated
Contact Plating
01 Normal
10 10 μ"

No. of Contact
06, 08, 10, 12, 14,
16, 20, 24, 26, 30,
34, 40, 44, 50, 68,
Color

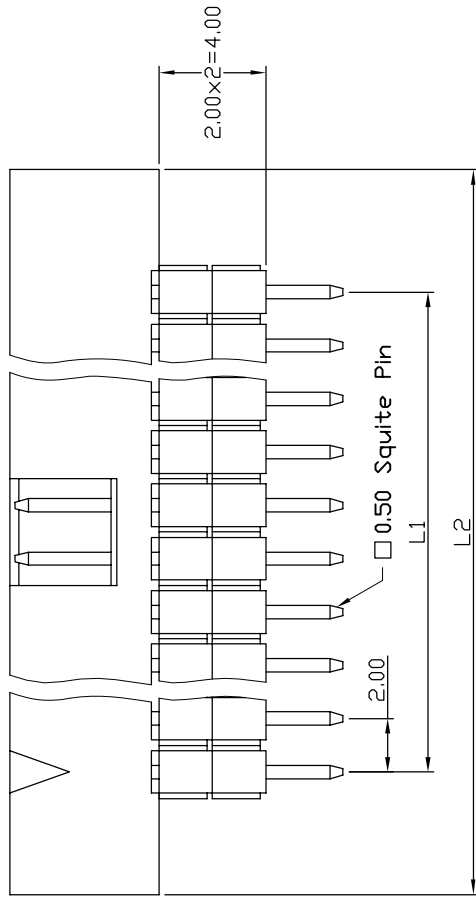
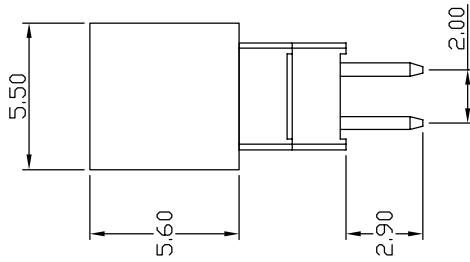
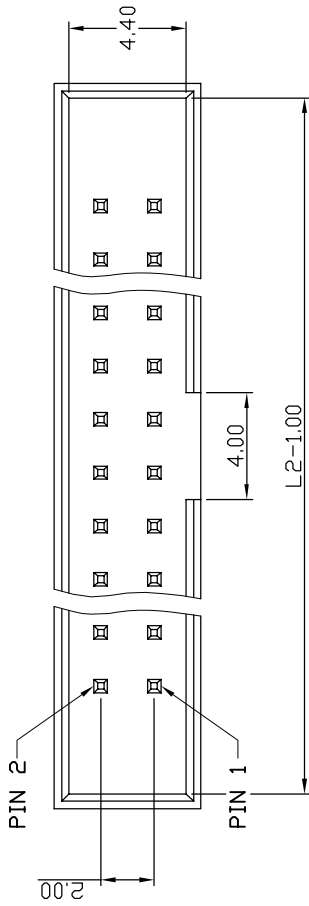

Ref.

成品規格圖		APP.	ANGLES	±3°	SIZE	A4
TITLE	2.00mm Box Header Straight Type	CHK.	LINEAR	0.0 ±0.38	SCALE	3:1
PART NO	23N6850-XXS20X-XXX			0.00±0.25	SHEET	1/1
DRW NO		DR.	KEN			
UNIT	mm(INCH)	PROJECT	96.01.04			

