

REV.	DESCRIPTION	DRW.	CHK.	APP.	DATE
A	RELEASE				

SPECIFICATIONS

Current Rating:
1 Amp
Insulator resistance:
1000 Megohms Min.
Contact resistance:
25 m ohms Max.
Dielectric withstanding:
AC 500V/minute
Operating Temperature:
-40° ~ +105°C
Contact Material:
Brass
Insulator Material:
High Temperature Thermoplastic
+Glass Fibre UL94V-0
Color: Black
Finish:
Gold, Tin or Duplex plated
Standard: Gold flash all over
Duplex plated:
Gold plated on contact area
Tin on solder area

RoHS Compliance

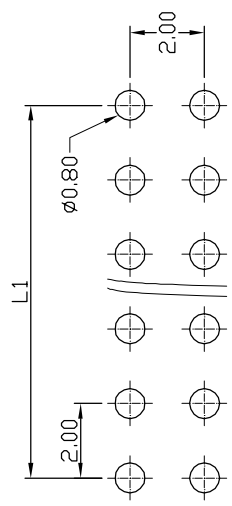

RECOMMENDED P. C. B. LAYOUT

Ordering information:
23N6850-XXS11X-XXX

N Nylon-6T
No. of Contact
06, 08, 10, 12, 14,
16, 20, 24, 26, 30,
34, 40, 44, 50, 68,
Color

G Gold Plated
T Tin Plated
H Duplex Plated
Contact Plating
01 Normal
10 10 μ"

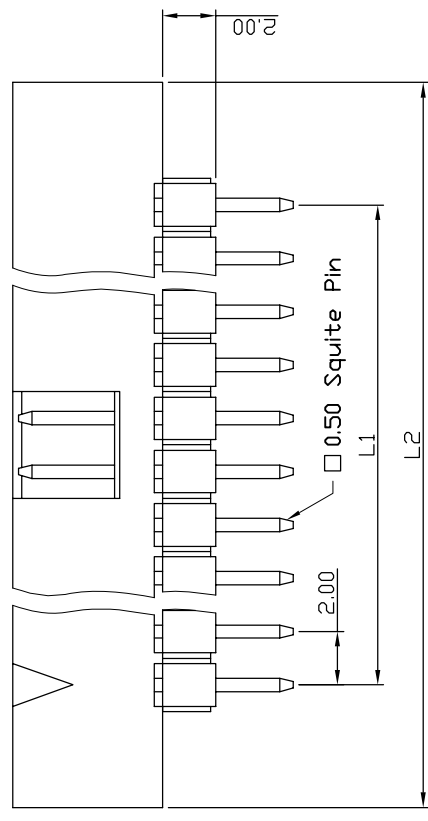
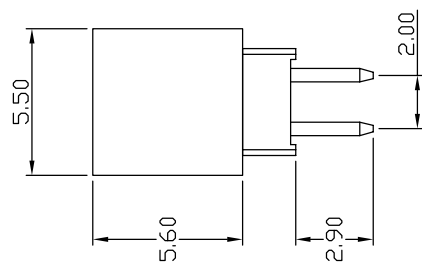
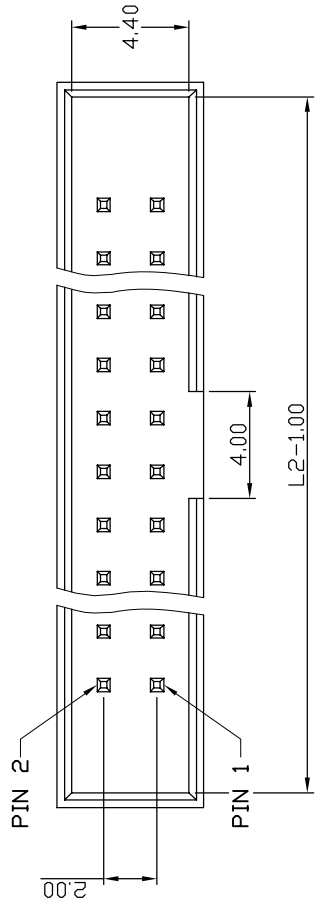

Ref.

TITLE		2.00mm Box Header Straight Type	CHK.	APP.	ANGLES	±3°	SIZE	A4
PART NO		23N6850-XXS11X-XXX			LINEAR	0.0 ±0.38	SCALE	3:1
DRW NO						0.00±0.25	SHEET	1/1
UNIT		mm(INCH)	PROJECT	◎				
			DR.	KEN				
								96.01.04

