

REV.	DESCRIPTION	DRW.	CHK.	APP.	DATE
A	RELEASE				

**SPECIFICATIONS**

Current Rating:  
1 Amp  
Insulator resistance:  
1000 Megohms Min.  
Contact resistance:  
25 m ohms Max.  
Dielectric withstanding:  
AC 500V/minute  
Operating Temperature:  
-40° ~ +105°C  
Contact Material:  
Brass  
Insulator Material:  
High Temperature Thermoplastic  
+Glass Fibre UL94V-0  
Color: Black  
Finish:  
Gold, Tin or Duplex plated  
Standard: Gold flash all over  
Duplex plated:  
Gold plated on contact area  
Tin on solder area

**RoHS Compliance**

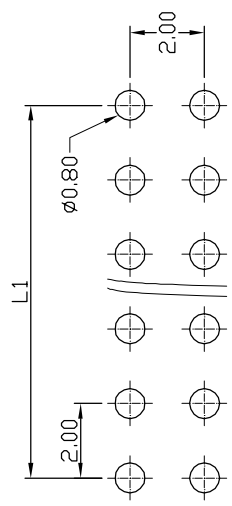

RECOMMENDED P. C. B. LAYOUT

**Ordering information:**  
23N6850-XXS10X-XXX

N Nylon-6T  
No. of Contact  
06, 08, 10, 12, 14,  
16, 20, 24, 26, 30,  
34, 40, 44, 50, 68,  
Color

G Gold Plated  
T Tin Plated  
H Duplex Plated  
Contact Plating  
01 Normal  
10 10 μ"

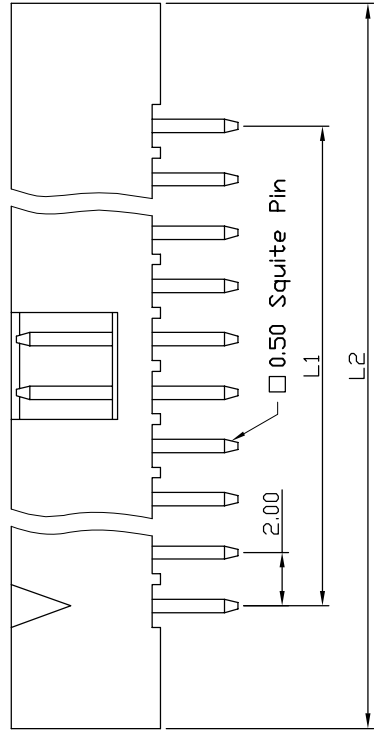
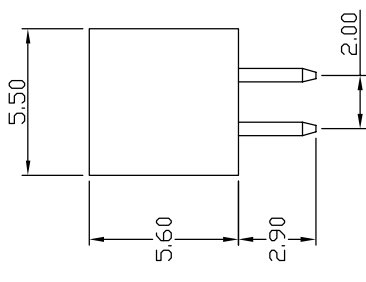
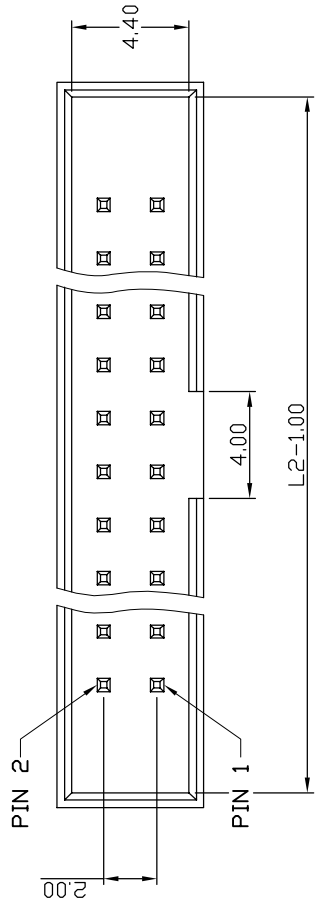

**Ref.**

TITLE	2.00mm Box Header Straight Type	CHK.	APP.	ANGLES	±3°	SIZE	A4
PART NO	23N6850-XXS10X-XXX			LINEAR	0.0	±0.38	SCALE 3:1
DRW NO					0.00±0.25		SHEET 1/1

UNIT	mm(INCH)	PROJECT	DR.	KEN	96.01.04

