

| REV. | DESCRIPTION | DRW. | CHK. | APP. | DATE |
|------|-------------|------|------|------|------|
| A | RELEASE | | | | |

SPECIFICATIONS

Current Rating:
1 Amp

Insulator resistance:
1000 Megohms Min.

Contact resistance:
25 m ohms Max.

Dielectric withstanding:
AC 500V/minute

Operating Temperature:
-40° ~ +105°C

Contact Material:
Brass

Insulator Material:
High Temperature Thermoplastic
+Glass Fibre UL94V-0

Color: Black

Finish:
Gold, Tin or Duplex plated
Standard: Gold flash all over
Duplex plated:
Gold plated on contact area
Tin on solder area

Ordering information:
23N6850-XXM00AX-XXX-A

N Nylon-6T

No. of Contact
06, 08, 10, 12, 14,
16, 20, 24, 26, 30,
34, 40, 44, 50, 68,

Color

Dimension Standard 7.50mm

G Gold Plated
T Tin Plated
H Duplex Plated

Contact Plating
01 Normal
10 10 μ"

| Cir- cuits | Dimension mm |
|---------------|--------------|
| 2x3 | L1 4.00 |
| 2x4 | L2 13.20 |
| 2x5 | 6.00 |
| 2x6 | 8.00 |
| 2x7 | 10.00 |
| 2x8 | 12.00 |
| 2x10 | 14.00 |
| 2x12 | 18.00 |
| 2x13 | 22.00 |
| 2x15 | 24.00 |
| 2x17 | 28.00 |
| 2x20 | 32.00 |
| 2x22 | 38.00 |
| 2x25 | 42.00 |
| 2x34 | 48.00 |
| | 66.00 |
| | 75.20 |

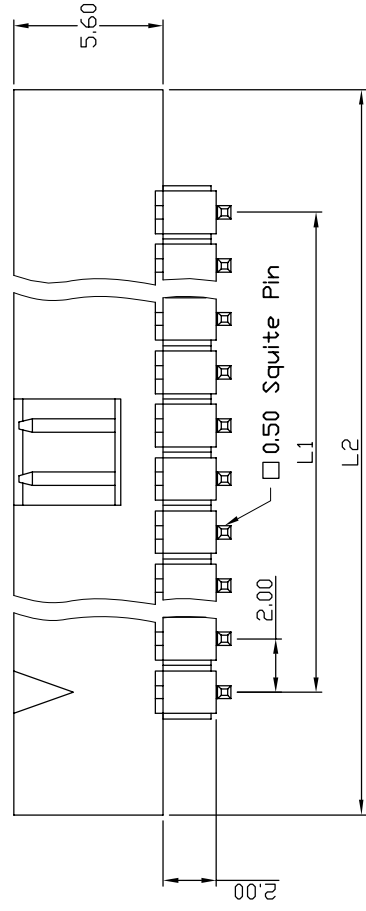
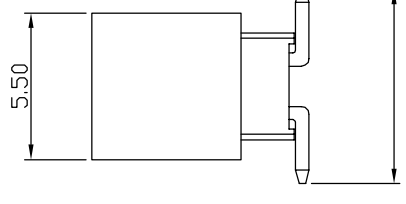
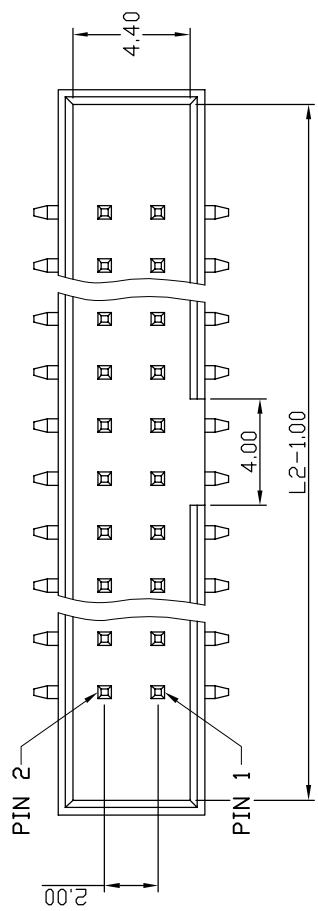

RoHS Compliance

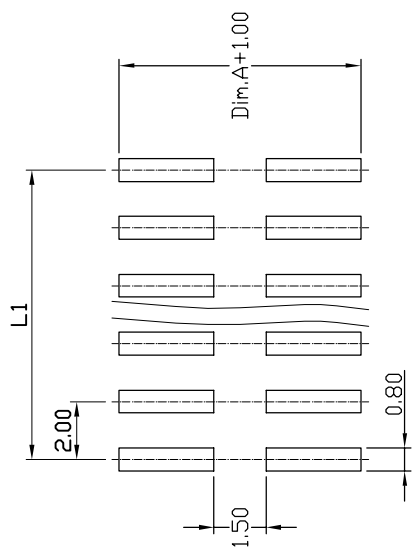

Ref.

| 成品規格圖 | | APP. | ANGLES | ±3° | SIZE | A4 |
|----------------------------------|----------|---------|----------|-----|-----------|-----------|
| TITLE 2.00mm Box Header SMT Type | | CHK. | LINEAR | | 0.0 ±0.38 | SCALE 3:1 |
| PART NO 23N6850-XXM00AX-XXX-A | | | | | 0.00±0.25 | SHEET 1/1 |
| DRW NO | | DR. | KEN | | | |
| UNIT | mm(INCH) | PROJECT | 96.01.04 | | | |



RECOMMENDED P. C. B. LAYOUT