

1	2	3	4	5	6	7	8
REV. DESCRIPTION	DRW. CHK. APP. DATE						
A	RELEASE						

SPECIFICATIONS

Current Rating:
 1 Amp
 Insulator resistance:
 1000 Megohms Min.
 Contact resistance:
 20 m ohms Max.
 Dielectric withstanding:
 AC 500V/minute
 Operating Temperature:
 -40° ~ +105°C
 Contact Material:
 BRASS
 Insulator Material:
 High Temperature Thermoplastic
 +Glass Fibre UL94V-0
 Color: Black
 Finish:
 Gold, Tin or Duplex plated
 Standard: Gold flash all over
 Duplex plated:
 Gold plated on contact area
 Tin on solder area

RoHS Compliance

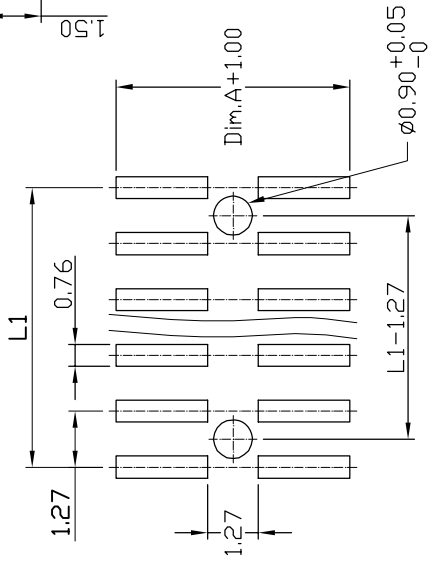

RECOMMENDED P. C. B. LAYOUT

Ordering information:
 23X6740-XXMXXPX-XXX-A

N Nylon-6T
 L LCP
 Number of Contact
 10-100
 Dimension
 50 = 5.00mm
 65 = 6.50mm
 XX = X.XXmm
 Color
 Contact Plating
 01 Normal
 10 10 μ"
 :
 :
 :
 G Gold Plated
 T Tin Plated
 H Duplex Plated
 Dimension
 Standard 5.50mm

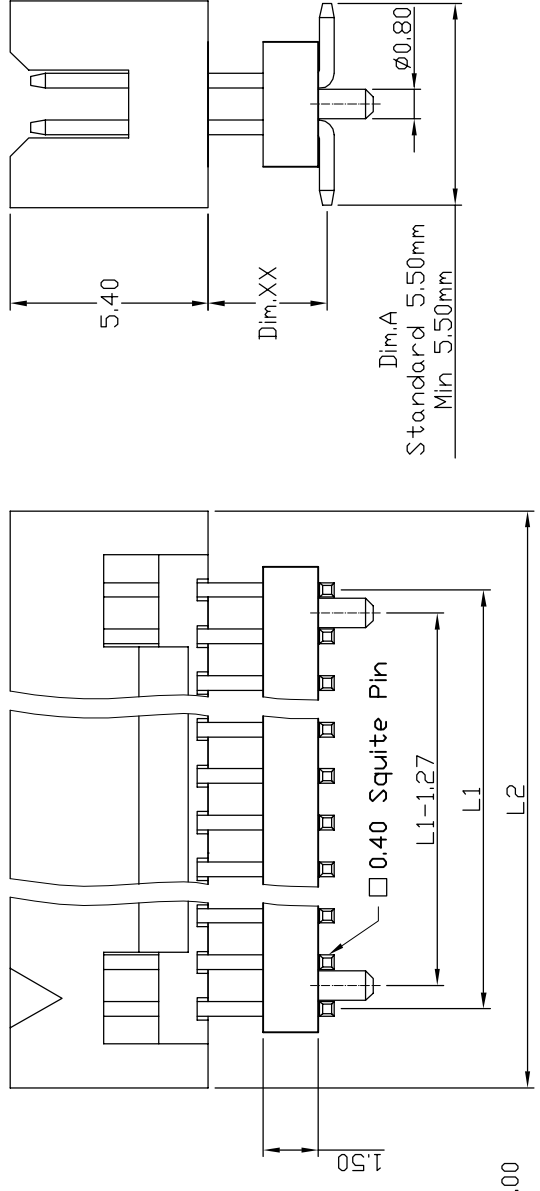
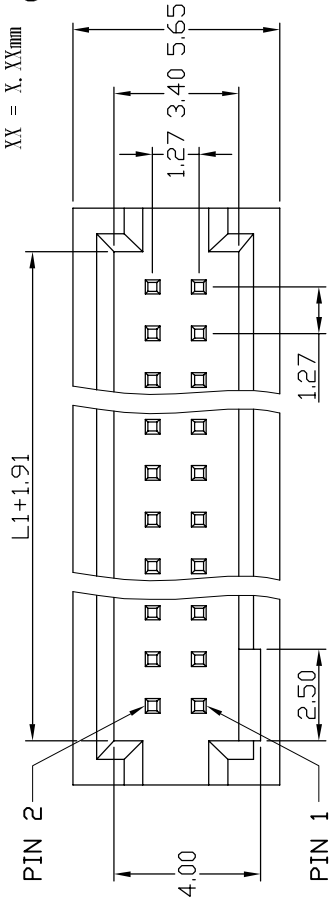

Ref.

ANGLES		±3°	SIZE	A4
LINEAR		0.0 ±0.38	SCALE	3:1
		0.00±0.25	SHEET	1/1
TITLE		1.27mm Box Header SMT Type		
PART NO		23X6740-XXMXXPX-XXX-A		
DRW NO		KEN		
UNIT		mm(INCH) PROJECT		
		96.01.04		

