

REV.	DESCRIPTION	DRW.	CHK.	APP.	DATE	Dimension mm		
						L1	L2	L3
A	RELEASE					2.54	10.11	8.56
						5.08	12.65	11.10
						6.35	13.92	12.37
						7.62	15.19	13.64
						8.89	16.46	14.91
						11.43	19.00	17.45
						13.97	21.54	19.99
						15.24	22.81	21.26
						16.51	24.08	22.53
						17.78	25.53	23.80
						20.32	27.89	26.34
						24.13	31.70	30.15
						26.67	34.24	32.69
						30.48	38.05	36.50
						36.83	44.40	42.85
						39.37	46.94	45.39
						41.91	49.48	47.93
						49.53	57.10	55.55
						62.23	69.80	68.25

Ordering information:

23X6740-XXMXXX-XXX-A-01

N Nylon-6T
L LCP

Number of Contact
06, 10, 12, 14, 16, 20, 22,
26, 28, 30, 34, 40, 44, 50,
60, 64, 68, 80, 100

Dimension
10 = 1.00mm
15 = 1.50mm
XX = X.XXmm

Color

Dimension Standard 6.50mm

G Gold Plated
T Tin Plated
H Duplex Plated

Contact Plating
01 Normal
10 10 μ"

SPECIFICATIONS

Current Rating:
1 Amp

Insulator resistance:
1000 Megohms Min.

Contact resistance:
20 m ohms Max.

Dielectric withstanding:
AC 500V/minute
Operating Temperature:
-40° ~ +105° C

Contact Material:
BRASS

Insulator Material:
High Temperature Thermoplastic
+Glass Fibre UL94V-0
Color: Black

Finish:
Gold, Tin or Duplex plated
Standard: Gold flash all over
Duplex plated:
Gold plated on contact area
Tin on solder area

RoHS Compliance

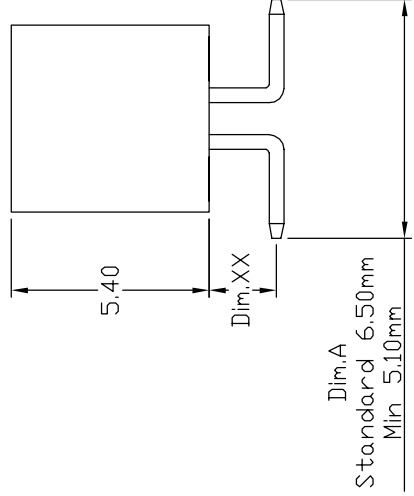
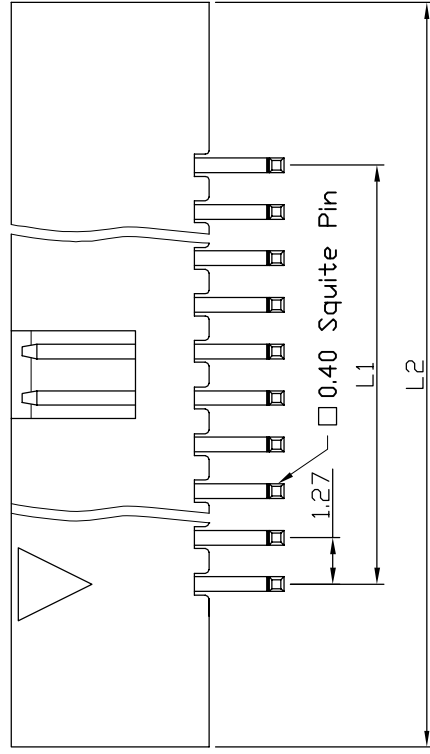
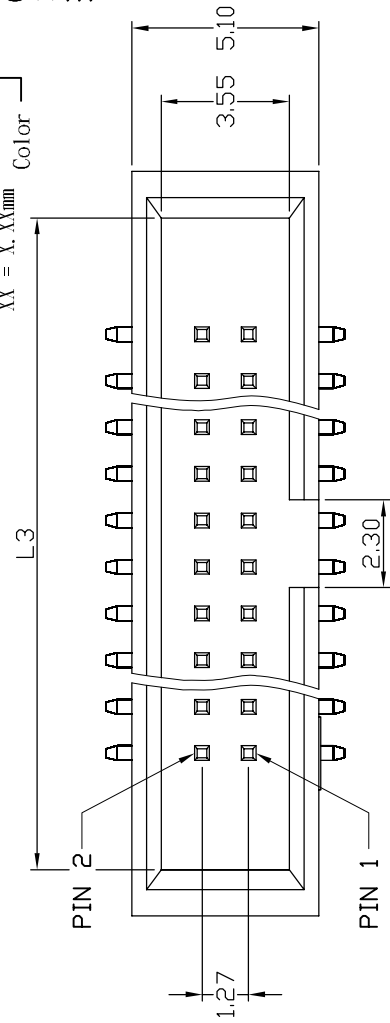
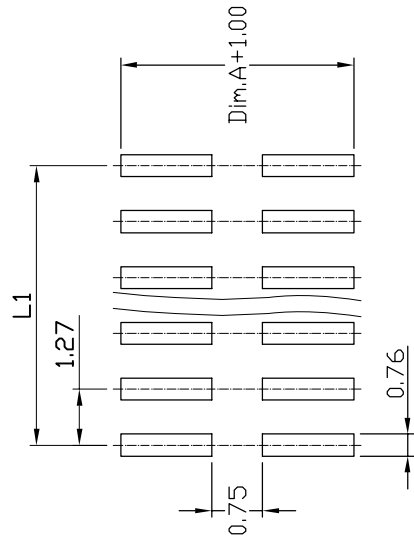

Ref.

成品規格圖		APP.	ANGLES ±3°	SIZE A4
TITLE	1.27mm Box Header SMT Type	CHK.	LINEAR	0.0 ±0.38 SCALE 3:1
PART NO	23X6740-XXMXXX-XXX-A-01			0.00±0.25 SHEET 1/1
DRW NO		DR.	KEN	
UNIT	mm(INCH)	PROJECT	◎	96.01.04



RECOMMENDED P. C. B. LAYOUT