

REV.	DESCRIPTION	DRW.	CHK.	APP.	DATE
A	RELEASE				

SPECIFICATIONS

Current Rating:

1 Amp

Insulator resistance:

1000 Megohms Min.

Contact resistance:

20 m ohms Max.

Dielectric withstanding:

AC 500V/minute

Operating Temperature:

-40° ~ +105°C

Contact Material:

BRASS

Insulator Material:

High Temperature Thermoplastic

+Glass Fibre UL94V-0

Color: Black

Finish:

Gold, Tin or Duplex plated

Standard: Gold flash all over

Duplex plated:

Gold plated on contact area

Tin on solder area

RoHS Compliance

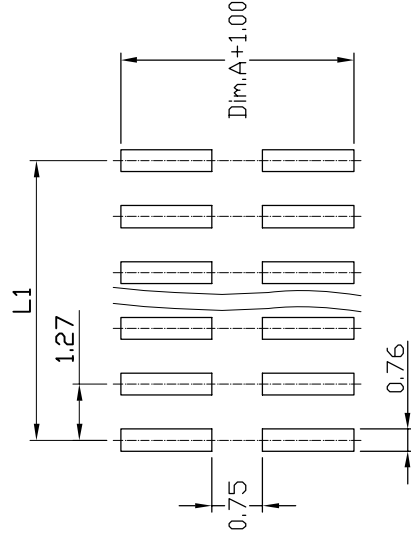

RECOMMENDED P. C. B. LAYOUT

Ordering information:

23X6740-XXM00X-XXX-A-01

N Nylon-6T
L LCP

Number of Contact

06, 10, 12, 14, 16, 20, 22,
26, 28, 30, 34, 40, 44, 50,
60, 64, 68, 80, 100

Color

Dimension
Standard 6.50mm

G Gold Plated

T Tin Plated

H Duplex Plated

Contact Plating

01 Normal

10 10 μ"

: :

: :

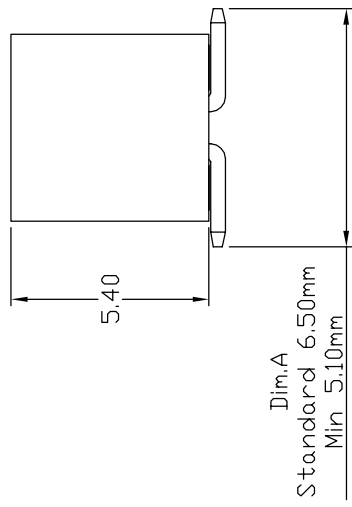
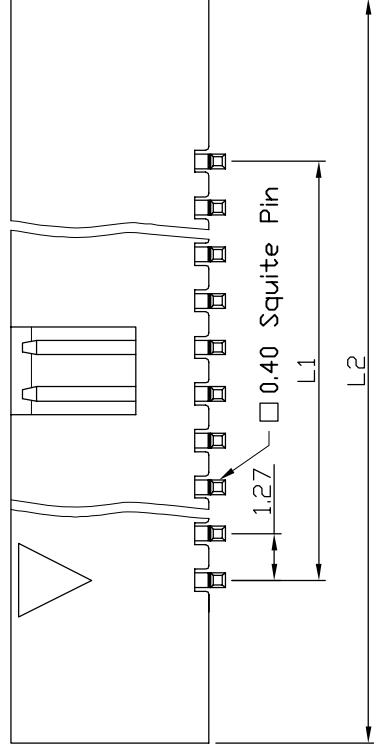
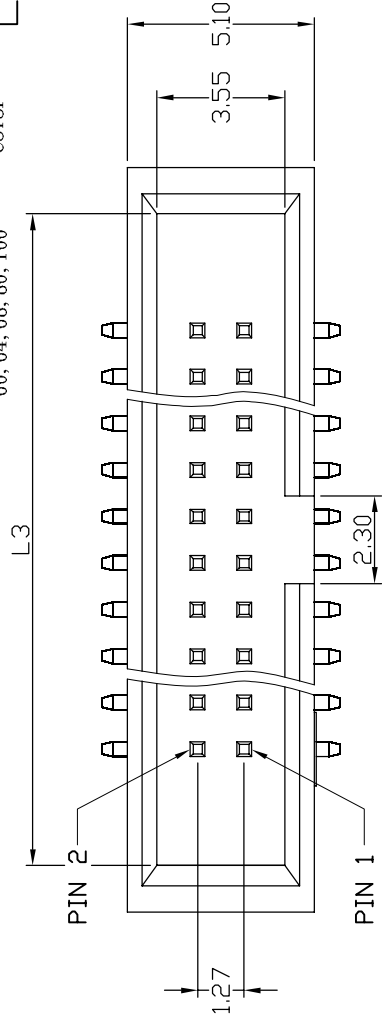

Ref.

成品規格圖

TITLE	1.27mm Box Header SMT Type	CHK.
PART NO	23X6740-XXM00X-XXX-A-01	
DRW NO		
UNIT	mm(INCH)	PROJECT
DR.	KEN	
	96.01.04	

ANGLES	±3°	SIZE	A4
LINEAR	0.0 ±0.38 <td>SCALE</td> <td>3:1</td>	SCALE	3:1
	0.00±0.25 <td>SHEET</td> <td>1/1</td>	SHEET	1/1



Cir-cuits	Dimension mm		
	L1	L2	L3
2X3	2.54	10.11	8.56
2X5	5.08	12.65	11.10
2X6	6.35	13.92	12.37
2X7	7.62	15.19	13.64
2X8	8.89	16.46	14.91
2X10	11.43	19.00	17.45
2X12	13.97	21.54	19.99
2X13	15.24	22.81	21.26
2X14	16.51	24.08	22.53
2X15	17.78	25.53	23.80
2X17	20.32	27.89	26.34
2X20	24.13	31.70	30.15
2X22	26.67	34.24	32.69
2X25	30.48	38.05	36.50
2X30	36.83	44.40	42.85
2X32	39.37	46.94	45.39
2X34	41.91	49.48	47.93
2X40	49.53	57.10	55.55
2X50	62.23	69.80	68.25